

A Safety Codes Officer will review your permit application for compliance with the National Building Code – 2019 Alberta Edition and/or B149.1-05 Gas Code. Important information will be added where necessary. A permit will then be issued and forwarded to your mailing address.

Inspection of the installation must be requested at the following stages:

- Prior to concealing the appliance and venting components.

Contact Building Inspection Services at 780-418-6601 at least 24 hours in advance.

It is the property owner's responsibility to obtain all required permits prior to commencement of the work and to ensure construction complies with the National Building Code – 2019 Alberta Edition.

- All fuel fired appliances must display a third party certification label confirming the appliance, the chimney and entire assembly have been tested in accordance with the minimum standard. (e.g. CSA, ULC or WH label affixed to the appliance and each section of chimney)



GENERAL INFORMATION

- All factory built fireplaces and stoves must be installed in strict conformance with the manufacturer's instructions and regulations in affect at the time of installation.
- A combustion air duct must be provided to all fuel fired appliances unless otherwise noted on the manufacturer's instructions.
- Masonry fireplaces and chimneys shall conform to Section 9.21 and Section 9.22 of the National Building Code – 2019 Alberta Edition.

WHERE TO APPLY

Permit applications may be submitted at:

Planning & Engineering Department
 2nd Floor, St. Albert Place
 5 St. Anne St.
 St. Albert, AB T8N 3Z9
 Office Hours: 8:00 am - 5:00 pm

Permit payment may be made by cash, personal cheque, credit card or debit card.

For more information, call **780-459-1654**.



FACTORY BUILT FIREPLACES, INSERTS, STOVES AND SPACE HEATERS

INFORMATION ON HOW TO APPLY FOR A BUILDING PERMIT



Building Inspection Services

A permit is required prior to installation of all fireplaces, inserts, stoves and space heaters. Wood burning appliances (solid fuel fired) require a building permit. Gas fired appliances require a gas permit.

Additional information may be required by a Building Safety Codes Officer prior to issuance of a permit.

MANUFACTURERS' SPECIFICATIONS

Manufactured gas and wood burning fireplaces are fabricated to meet performance standards. Required clearances are specific to each model. The product's installation manual must be consulted and made available for inspection.

TYPICAL DRAWINGS REQUIRED

Example of PLAN SHOWING LOCATION OF PROPOSED FIREPLACE

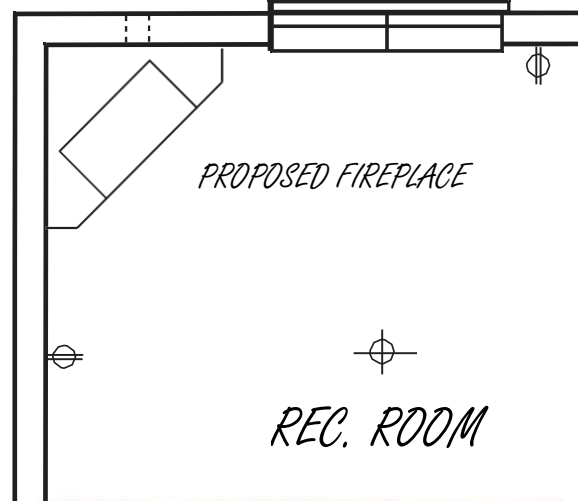

APPLICATION PROCEDURE

- Submit a drawing showing the intended location of the appliance within the building.
- Provide a copy of the manufacturers' specifications showing the name, model number and third party testing agency.
- Complete a building permit application for wood burning appliances or
- Complete a gas permit application form for gas fired appliances.

OTHER REQUIRED PERMITS

For Plumbing, Gas and Electrical Permits call 780-459-1654.

For further information regarding permit applications and the Alberta building regulations, please contact Building Inspection Services at 780-418-6601.

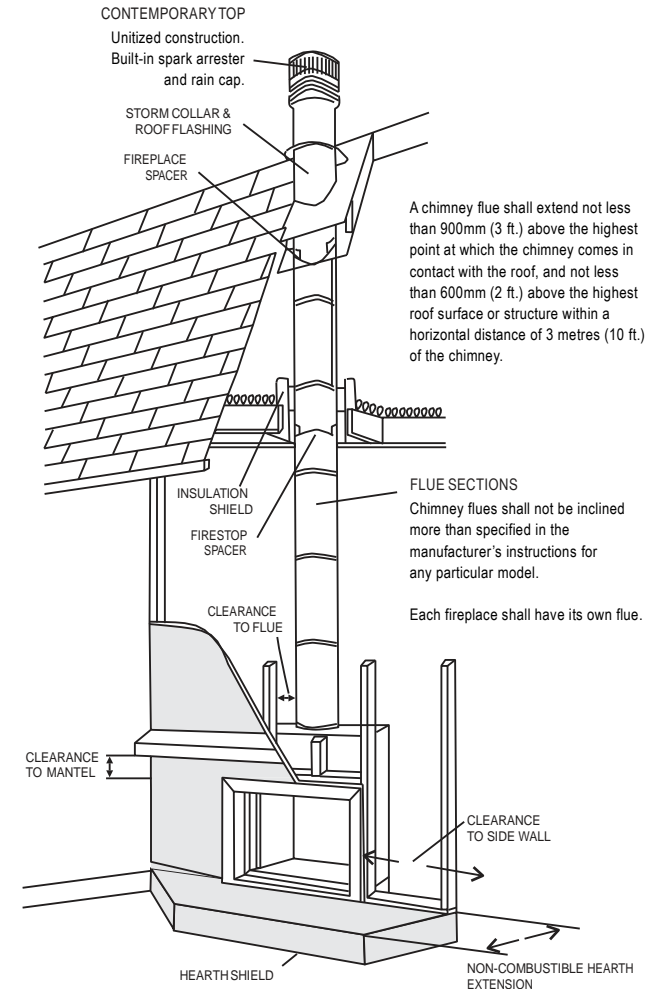

FACTORY BUILT FIREPLACES, INSERTS, STOVES AND SPACE HEATERS